

		ISO R 2084 DIN - 2501 BS - 4504						ANSI B 16.5					B.S. 10 1962							
NOM SIZE	DIAM	PN 100	PN 64	PN 40	PN 25	PN 16	PN 10	ASA 1500	ASA 900	ASA 600	ASA 300	ASA 150	BSTT 100	BSTS 100	BSTR 64	BSTJ 40	BSTH 25	BSTF 25	BSTE 16	BSTD 10
50mm	D	195	180	165	165	165	165	216	216	165	165	152.4	184	171	165	165	165	165	153	153
	b	28	26	19	19	20	20	-	-	31.8	22.2	19	34.9	31.8	25.4	25.4	19	19	19	20.5
	d1	102	102	102	102	102	102	-	-	92	92	92	102	89	102	102	102	102*	90*	90*
	f	3	3	3	3	3	3	-	-	6.4	1.6	1.6	1.6*	1.6*	1.6*	1.6*	1.6*	1.6*	1.6*	1.6*
	k	145	135	125	125	125	125	165	165	127	127	120.6	146	133	127	127	127	127	114	114
	d2	26	22	18	18	18	18	25	25	19	19	19	22	22	19	22	18	18	18	18
	n	4	4	4	4	4	4	8	8	8	8	4	8	8	8	4	4	4	4	4
80mm	D	230	215	200	200	200	200	267	241	209.5	209.5	190.5	235	203	203	203	203	203	183	183
	b	34	30	19	19	22	22	-	-	38	28.6	23.8	47.6	35	31.8	31.8	22	22	22	20.5
	d1	138	138	138	138	138	138	-	-	127	127	127	127	114	127	127	127	127*	122*	122*
	f	3	3	3	3	3	3	-	-	6.4	1.6	1.6	1.6*	1.6*	1.6*	1.6*	1.6*	1.6*	1.6*	1.6*
	k	180	170	160	160	160	160	203	190.5	168.3	168.3	152.4	190.5	165	165	165	165	165	146	146
	d2	26	22	18	18	18	18	32	25	22	22	19	29	25	22	22	18	18	18	18
	n	8	8	8	8	8	8	8	8	8	8	4	8	8	8	8	8	8	4	4
100mm	D	265	250	235	235	220	220	311	292	273	254	228.6	286	248	241	229	229	229	216	216
	b	36	32	19	19	24	24	-	-	44.4	31.7	23.8	57.2	41.3	35	34.9	25	25	25	22
	d1	210	162	162	162	158	158	-	-	157.2	157.2	157.2	159	159	152	152	152	152*	152*	152*
	f	3	3	3	3	3	3	-	-	6.4	1.6	1.6	1.6*	1.6*	1.6*	1.6*	1.6*	1.6*	1.6*	1.6*
	k	210	200	190	190	180	180	241.5	235	216	200	190.5	235	203	197	190	190	190	178	178
	d2	30	26	22	22	18	18	35	32	25	22	19	32	29	25	22	18	18	18	18
	n	8	8	8	8	8	8	8	8	8	8	8	8	8	8	8	8	8	8	4
150mm	D	355	345	300	300	285	285	394	381	355.6	317.5	279.4	375	324	305	305	305	305	279	279
	b	48	36	26	20	26	26	-	-	54	36.5	25.4	73	50.8	44.5	38.1	29	29	25.2	23.6
	d1	218	218	218	218	212	212	-	-	216	216	212	229	209	209	209	209	209*	209*	209*
	f	3	3	3	3	3	3	-	-	6.4	1.6	1.6	1.6*	1.6*	1.6*	1.6*	1.6*	1.6*	1.6*	1.6*
	k	290	280	250	250	240	240	317.5	317.5	292	270	241.3	317.5	273	260	260	260	260	235	235
	d2	33	33	26	26	22	22	38	32	29	22	22	35	29	25	25	22	22	22	18
	n	12	8	8	8	8	8	12	12	12	12	8	12	12	12	12	12	12	8	8
200mm	D	430	415	375	360	340	340	483	470	419	381	343	476	413	368	368	368	368	337	337
	b	60	46	30	22	30	26	-	-	62	41.3	28.6	88.9	63.5	50.8	41.3	32	32	28.4	25.2
	d1	270	285	285	278	268	268	-	-	270	270	270	298.5	273	260	260	260	260*	260*	260*
	f	3	3	3	3	3	3	-	-	6.4	1.6	1.6	1.6*	1.6*	1.6*	1.6*	1.6*	1.6*	1.6*	1.6*
	k	360	345	320	310	295	295	393.5	393.5	349.3	330.2	298.4	406.5	356	324	324	324	324	292	292
	d2	36	36	30	26	22	22	44	38	32	25	22	41	35	29	25	22	22	22	18
	n	12	12	12	12	12	8	12	12	12	12	8	12	12	12	12	12	12	8	8
Material	Cast Steel			Ductile cast Iron	Grey Cast Iron			For All Metals					Cast Steel			Ductile cast Iron	Grey Cast Iron			

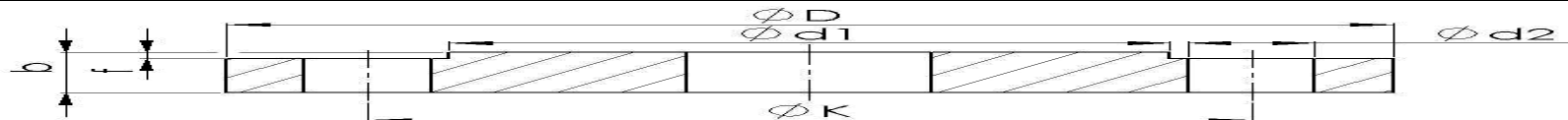

\* Raised face dimensions as a recommendation only!

Whilst every care has been taken in the preparation of this guide, no responsibility can be taken for any errors or omissions.

A.R.I. FLANGE STANDARD TABLE - second edition



		ISO R 2084 DIN - 2501 BS - 4504						ANSI B 16.5					B.S. 10 1962							
NOM SIZE	DIAM	PN 100	PN 64	PN 40	PN 25	PN 16	PN 10	ASA 1500	ASA 900	ASA 600	ASA 300	ASA 150	BSTT 100	BSTS 100	BSTR 64	BSTJ 40	BSTH 25	BSTF 25	BSTE 16	BSTD 10
250mm	D	505	470	450	425	405	394	584	546	508	444.5	406.4	559	483	432	432	432	432	406	406
	b	72	54	34.5	24.5	32	28	-	-	69.9	47.6	30.2	108	73	57.2	47.6	35	35	28.4	28.4
	d1	345	345	345	335	320	320	-	-	324	323.8	323.8	330	330	311	311	311	311*	311*	311*
	f	3	3	3	3	3	3	-	-	6.4	1.6	1.6	1.6*	1.6*	1.6*	1.6*	1.6*	1.6*	1.6*	1.6*
	k	430	400	385	370	355	350	482.5	470	431.8	387.3	362	489	425	387	381	381	381	356	356
	d2	39	36	33	30	26	22	51	38	35	29	25	41	35	29	29	25	25	22	22
10"	n	12	12	12	12	12	12	12	16	16	16	12	16	16	16	12	12	12	12	8
	D	585	530	515	485	460	445	673	610	558.3	520.7	482.6	654	578	508	489	489	489	458	458
	b	84	62	39.5	27.5	32	28	-	-	73.1	50.3	31.7	120.7	82.6	63.5	50.8	38	38	31.6	28.4
	d1	410	410	410	395	378	370	-	-	381	381	381	413	381	362	362	362	362*	362*	362*
	f	4	4	4	4	4	4	-	-	6.4	1.6	1.6	1.6*	1.6*	1.6*	1.6*	1.6*	1.6*	1.6*	1.6*
	k	500	460	450	430	410	400	571.5	533.5	489	450.8	431.8	571.5	508	457	438	438	438	406	406
12"	d2	42	36*	33	30	26	22	54	38	35	32	25	48	42	32	29	25	25	25	22
	n	16	16	16	16	12	12	16	20	20	16	12	16	16	16	16	16	16	12	12
	D	655	600	580	555	520	505	749	641	603.2	584.2	533.4	-	648	584	552	552	552	527	527
	b	95	72	44	30	36	30	-	-	76.4	54	35	-	95.3	69.9	57	41	41	34.8	31.6
	d1	465	465	465	450	438	430	-	-	412.7	412.7	412.7	-	438	419	419	419	419*	419*	419*
	f	4	4	4	4	4	4	-	-	6.4	1.6	1.6	-	1.6*	1.6*	1.6*	1.6*	1.6*	1.6*	1.6*
14"	k	560	525	510	490	470	460	635	559	527	514.3	476.2	-	578	527	495	495	495	470	470
	d2	48	39	36	33	26	22	60	41	38	32	29	-	42	35	32	29	29	25	25
	n	16	16	16	16	16	16	16	20	20	20	12	-	20	16	16	16	16	12	12
	D	715	670	660	620	580	565	826	705	686	647.7	597	-	743	641	610	610	610	578	578
	b	106	78	48	32	38	30	-	-	82.6	57	36.5	-	108	76.2	63.5	45	45	34.8	31.6
	d1	535	535	535	505	490	482	-	-	470	470	470	-	495	483	483	483	483*	483*	483*
16"	f	4	4	4	4	4	4	-	-	6.4	1.6	1.6	-	1.6*	1.6*	1.6*	1.6*	1.6*	1.6*	
	k	620	585	585	550	525	515	705	616	603	571.5	539.7	-	660	584	552	552	552	521	521
	d2	48	42*	39	36	30	26	67	44	41	35	29	-	48	35	32	29	29	25	25
	n	16	16	16	16	16	16	16	20	20	20	16	-	20	20	20	20	20	12	12
	D	-	-	685	670	640	615	914	787	743	711.2	635	-	-	737	673	673	673	641	641
	b	-	-	49	34.5	40	32	-	-	88.9	60.3	39.7	-	-	82.6	69.9	48	48	38	34.8
18"	d1	-	-	560	555	550	532	-	-	533.4	533.4	533.4	-	-	571	533	533	533*	553*	553*
	f	-	-	4	4	4	4	-	-	6.4	1.6	1.6	-	-	1.6*	1.6*	1.6*	1.6*	1.6*	
	k	-	-	610	600	585	565	774.5	686	654	628.6	577.8	-	-	673	610	610	610	584	584
	d2	-	-	39	36	30	26	73	51	44	35	32	-	-	38	35	32	32	25	25
	n	-	-	20	20	20	20	16	20	20	24	16	-	-	20	20	20	20	16	12
	Material	Cast Steel			Ductile cast Iron	Grey Cast Iron			For All Metals					Cast Steel			Ductile cast Iron	Grey Cast Iron		

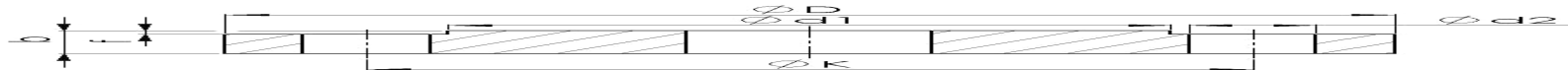

\* Raised face dimensions as a recommendation only!

Whilst every care has been taken in the preparation of this guide, no responsibility can be taken for any errors or omissions.

		ISO R 2084 DIN - 2501 BS - 4504						ANSI B 16.5					B.S. 10 1962							
NOM SIZE	DIAM	PN 100	PN 64	PN 40	PN 25	PN 16	PN 10	ASA 1500	ASA 900	ASA 600	ASA 300	ASA 150	BSTT 100	BSTS 100	BSTR 64	BSTJ 40	BSTH 25	BSTF 25	BSTE 16	BSTD 10
500mm	D	870	800	755	730	715	670	984	857	813	775	698	-	-	806	737	737	737	705	705
	b	-	-	52	36.5	42	34	-	-	95.2	64	43	-	-	88.9	79.4	51	51	41.1	34.8
	d1	615	615	615	615	610	585	-	-	584	584	585	-	-	622	597	597	597*	597*	597*
	f	-	4	4	4	4	4	-	-	6.4	1.6	1.6	-	-	1.6*	1.6*	1.6*	1.6*	1.6*	1.6*
	k	760	705	670	660	650	620	832	749.5	724	685.8	635	-	-	730	673	673	673	641	641
	d2	56	48*	42	36	33	26	79	54	44	35	32	-	-	42	35	32	32	25	25
	n	20	20	20	20	20	20	16	20	24	24	20	-	-	20	24	24	24	16	16
600mm	D	990	930	890	845	840	780	1168	1041	940	914	813	-	-	-	851	851	851	826	826
	b	-	-	58	42	48	36	-	-	108	70	48	-	-	-	92	57	57	44.3	38
	d1	735	735	735	720	725	685	-	-	692	692	692	-	-	-	698	698	698*	698*	698*
	f	-	5	5	5	5	5	-	-	6.4	1.6	1.6	-	-	-	1.6*	1.6*	1.6*	1.6*	1.6*
	k	875	820	795	770	770	725	990.5	901.5	838	813	749	-	-	-	781	781	781	756	756
	d2	62	56*	48	39	36	30	92	67	51	42	35	-	-	-	38	32	32	32	29
	n	20	20	20	20	20	20	16	20	24	24	20	-	-	-	24	24	24	16	16
700mm	D	1145	1045	995	960	910	895	-	-	1073	1035	927	-	-	-	-	-	-	-	-
	b	-	-	-	46.5	54	40	-	-	117.4	86	52	-	-	-	-	-	-	-	-
	d1	840	840	840	820	795	800	-	-	800	800	794	-	-	-	-	-	-	-	-
	f	-	5	5	5	5	5	-	-	6.4	1.6	1.6	-	-	-	-	-	-	-	-
	k	1020	935	900	875	840	840	-	-	965	940	864	-	-	-	-	-	-	-	-
	d2	70	56*	48	42	36	30	-	-	54	44	35	-	-	-	-	-	-	-	-
	n	24	24	24	24	24	24	-	-	28	28	28	-	-	-	-	-	-	-	-
750mm	D	-	-	-	-	-	-	-	-	1130	1092	984	-	-	-	-	-	-	997	-
	b	-	-	-	-	-	-	-	-	120.6	92	54	-	-	-	-	-	-	50.6	-
	d1	-	-	-	-	-	-	-	-	857	857	857	-	-	-	-	-	-	889*	-
	f	-	-	-	-	-	-	-	-	6.4	1.6	1.6	-	-	-	-	-	-	1.6*	-
	k	-	-	-	-	-	-	-	-	1022	997	914	-	-	-	-	-	-	927	-
	d2	-	-	-	-	-	-	-	-	54	48	35	-	-	-	-	-	-	32	-
	n	-	-	-	-	-	-	-	-	28	28	28	-	-	-	-	-	-	20	-
800mm	D	-	1165	1140	1085	1025	1015	-	-	-	-	-	-	-	-	-	-	-	-	-
	b	-	-	-	51	58	44	-	-	-	-	-	-	-	-	-	-	-	-	-
	d1	-	960	960	940	900	900	-	-	-	-	-	-	-	-	-	-	-	-	-
	f	-	-	5	5	5	5	-	-	-	-	-	-	-	-	-	-	-	-	-
	k	-	1050	1030	990	950	950	-	-	-	-	-	-	-	-	-	-	-	-	-
	d2	-	62*	56	48	39	33	-	-	-	-	-	-	-	-	-	-	-	-	-
	n	-	24	24	24	24	24	-	-	-	-	-	-	-	-	-	-	-	-	-
Material	Cast Steel			Ductile cast Iron	Grey Cast Iron			For All Metals					Cast Steel			Ductile cast Iron	Grey Cast Iron			

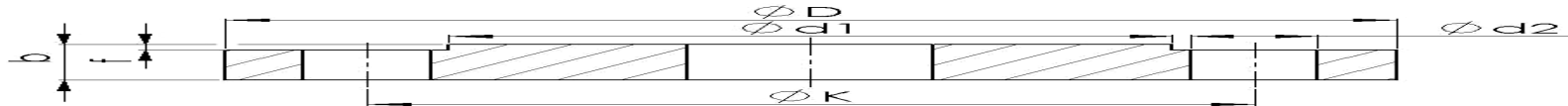

\* Raised face dimensions as a recommendation only!

Whilst every care has been taken in the preparation of this guide, no responsibility can be taken for any errors or omissions.

